

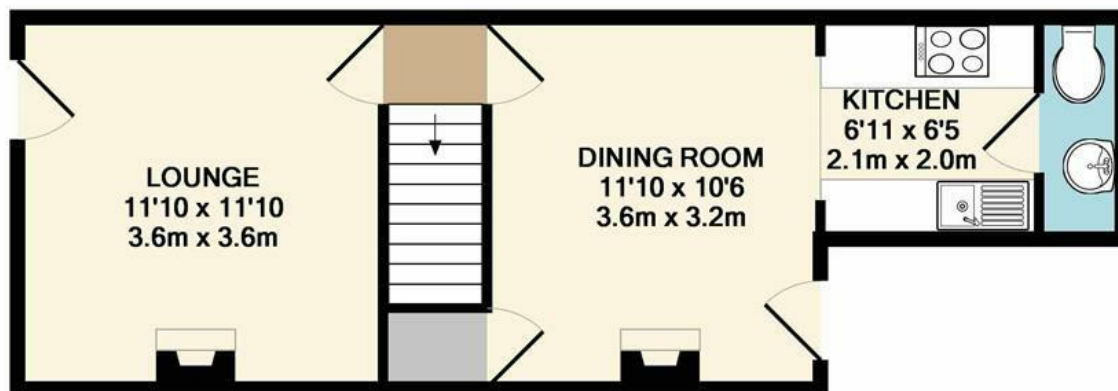

Morley Street | Norwich | NR3  
 Guide Price £200,000

abbotFox



GROUND FLOOR  
 APPROX. FLOOR  
 AREA 363 SQ.FT.  
 (33.7 SQ.M.)

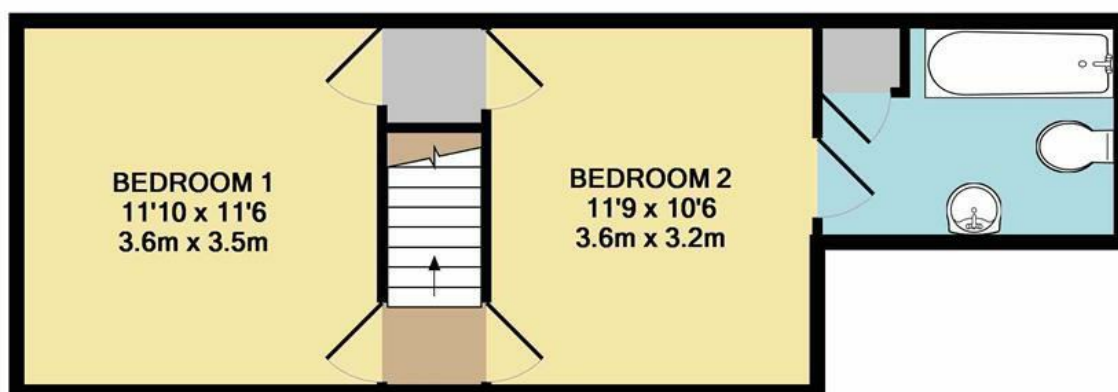

1ST FLOOR  
 APPROX. FLOOR  
 AREA 362 SQ.FT.  
 (33.7 SQ.M.)

TOTAL APPROX. FLOOR AREA 725 SQ.FT. (67.4 SQ.M.)

Whilst every attempt has been made to ensure the accuracy of the floor plan contained here, measurements of doors, windows, rooms and any other items are approximate and no responsibility is taken for any error, omission, or mis-statement. This plan is for illustrative purposes only and should be used as such by any prospective purchaser. The services, systems and appliances shown have not been tested and no guarantee as to their operability or efficiency can be given  
 Made with Metropix ©2019

Energy Efficiency Rating		
	Current	Potential
Very energy efficient - lower running costs		
(92 plus) A		
(81-91) B		
(69-80) C		
(55-68) D		
(39-54) E		
(21-38) F		
(1-20) G		
Not energy efficient - higher running costs		
<b>England &amp; Wales</b>		
		EU Directive 2002/91/EC

Disclaimer – In accordance with the Property Misdescriptions Act, the company gives notice that all descriptions, references to condition, necessary permissions for use and other details are given in good faith and believed to be correct, but any intending lessees do not rely on them as statements of fact, but must satisfy themselves by inspection or other means, as to their accuracy.



abbotFox presents this stylish terraced house located in the popular NR3 postcode of Norwich. This home offers a sense of light and style throughout. With accommodation comprising of two reception rooms, kitchen and cloakroom to the ground floor, the first floor offers two generous double bedrooms and a family bathroom. Ideally located within easy reach of a variety of local amenities and Norwich City Centre, this is the ideal opportunity for any first time buyer or buy-to-let investor. An internal viewing comes highly recommended.

Agents Note: In accordance with Section 21 of the Estate Agents Act 1979 we would advise all interested parties that the vendor of this property is an associate of abbotFox.

The highly sought after NR3 area of Norwich sits just north of the City Centre, providing a range of amenities such as; shops, public houses, Waterloo Park, restaurants, Hollywood Cinemas and the Anglia Square shopping centre, which has recently been approved for renovation. The vibrant City of Norwich is accessible by foot or a variety of regular bus routes are available including services to the City Centre, University of East Anglia, Norwich & Norfolk Hospital, Attleborough and many more making this location highly convenient for travelling in and around Norwich and the county of Norfolk.

